



# USER'S MANUAL | AG Series Safe

## FIRST TIME OPERATION



OPERATE VIDEO

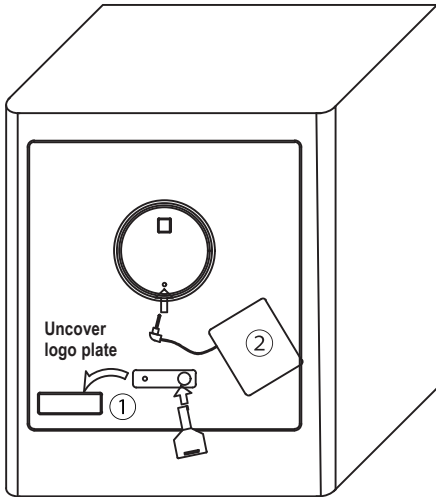

### ① Open with Emergency Key

Insert the emergency key and turn the key counter-clockwise

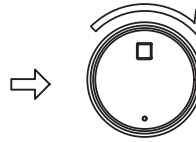

Do not release the key; rotate the handle to open door at the same time.

### ② Open with Emergency Battery Box

Connect the Emergency Battery Box into the power jack inlet

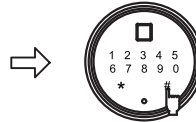

Default Admin Code: 123456

Input default admin code or any fingerprint, press “#” to confirm.



Green light on, rotate the handle within 6 seconds to open.

## OPENING THE SAFE



Touch the panel to activate, the screen will light up.



Input passcode or fingerprint, press “#” to confirm.



Green light on, rotate the handle within 6 seconds to open.

## SETTING UP USER CODE

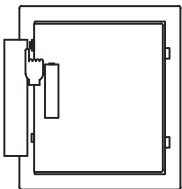

Press the Set Button at the back of the door for 1 second then release.

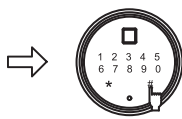

Input admin code, press “#” to confirm.

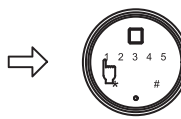

Press “1” to set up user code.

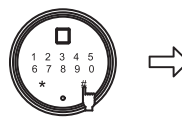

Enter your new passcode followed by “#”. *Repeat this step.*



Green light on, indicating set up successful.

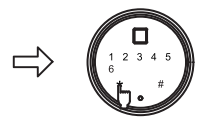

Press “\*” to exit.

## SETTING UP ADMIN CODE

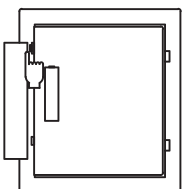

Press the Set Button at the back of the door for 1 second then release.

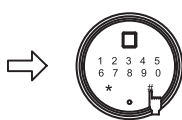

Input admin code, press “#” to confirm.

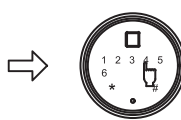

Press “4” to set up/change admin code.



Enter your new passcode followed by “#”. *Repeat this step.*



Green light on, indicating set up successful.

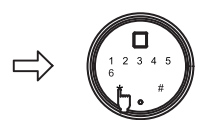

Press “\*” to exit.

## REGISTER FINGERPRINT (Stores up to 30 fingerprints)

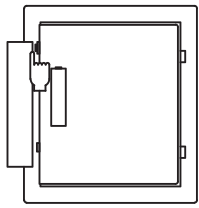

Press the Set Button at the back of the door for 1 second then release.

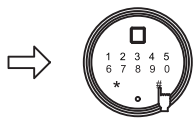

Input admin code, press “#” to confirm.

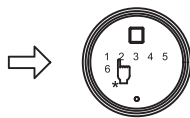

Press “2” to register a fingerprint.

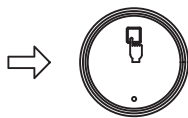

Scan your fingerprint for 3 times.

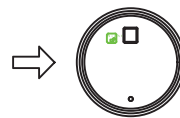

Green light on, indicating set up successful.

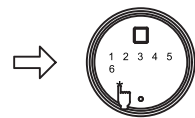

Press “\*” to exit.

## DELETE FINGERPRINT

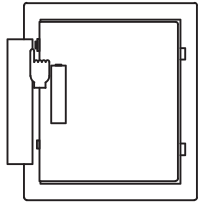

Press the Set Button at the back of the door for 1 second then release.

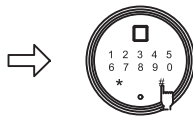

Input admin code, press “#” to confirm.

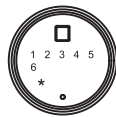

Press “3” to delete a fingerprint.



Green light on, indicating set up successful.

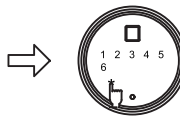

Press “\*” to exit.

## SWITCH ACCESS MODE

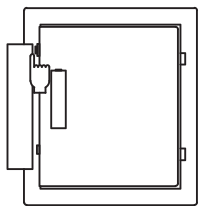

Press the Set Button at the back of the door for 1 second then release.

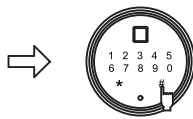

Input admin code, press “#” to confirm.

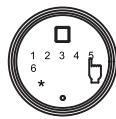

Press “5” to select an access mode.

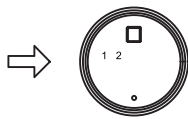

Pick a mode by selecting “1” or “2”.



Press “1” for **General Mode** (Quick access by code or fingerprint)

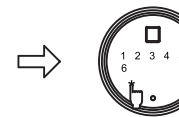

Press “\*” to exit.



Press “2” for **Extra Security Mode** (Requires both code and fingerprint to access)

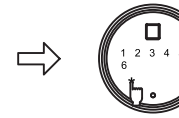

Press “\*” to exit.

## ALARM FUNCTION



Input passcode or fingerprint, press “#” to confirm.



Press “\*” to activate alarm function.



Green light on, indicating the alarm mode on.



The alarm will sound under 2 circumstances:  
 1. When the safe is subjected to violent vibration  
 2. 5 continuously false entries will also activate the alarm  
 \*Stop the alarm by entering correct code/fingerprint.

## RESTORE FACTORY SETTINGS

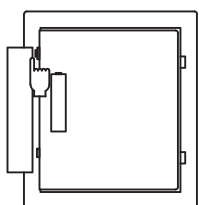

Press and hold the Set Button at the back of the door for 3-4 seconds.



Green light on, indicating all of the programmed codes and fingerprints has been erased.



T: 0397204333  
 E: info@securepro.au